

THIS COPY IS PROVIDED ON A RESTRICTED BASIS AND IS NOT TO BE USED IN ANY WAY DETRIMENTAL TO THE INTERESTS OF PANDUIT CORP.

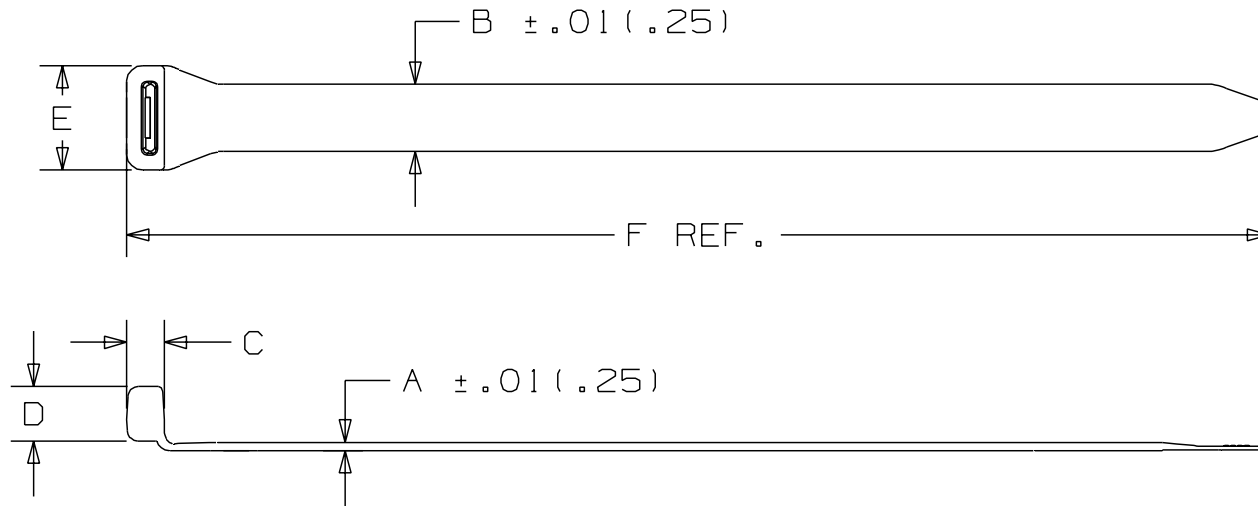

PANDUIT PART NO.	BUNDLE DIA.		A in (mm)	B in (mm)	C in (mm)	D in (mm)	E in (mm)	F in (mm)	MIN. LOOP TENSILE lbs (N)	WEIGHT lbs/100 pcs. (g)
	MIN. in (mm)	MAX. in (mm)								
ERT2M	.375 (9.5)	2.35 (59.7)	.090 (2.29)	.500 (12.70)	.323 (8.2)	.406 (10.3)	.841 (21.36)	8.5 (216)	18 (80)	1.01 (458)

NOTES:

- SEE CURRENT PRICE SHEET FOR PART NUMBER SUFFIX DESIGNATION FOR PACKAGE SIZE AND PART COLOR.

CAD FILENAME/LAYERS W10001CK/02

PANDUIT CORP. TINLEY PARK, ILLINOIS

ERT SERIES CABLE TIE

UNLESS OTHERWISE SPECIFIED,  
DIMENSIONAL TOLERANCES ARE:  
(.X) ± .01 (.25) (.XXX) ± .020 (.51)  
(.XX) ± .02 (.5) ANGLES ± ---

UNLESS OTHERWISE SPECIFIED,  
ALL DIMENSIONS ARE GIVEN  
IN INCHES, THIRD ANGLE PROJECTION.

DRAWN BY  
ERW

MAT'L:

SCALE NONE

DATE  
12/26/07

TPU

DRAWING NO.

SS-27570

DWG  
A  
SIZE

REV	DATE	BY	CHK	DESCRIPTION	ECN	R	CUST	SUP
2	2/1/08	ERW		UPDATED DIMENSIONS. SEE ECN FOR DETAILS.	SS-27570	2		