

PART NUMBER 10046971-001LF

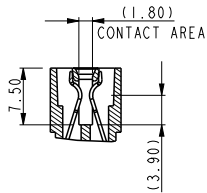

SECTION C-C

SECTION F-F  
BOARD RETENTION PINS

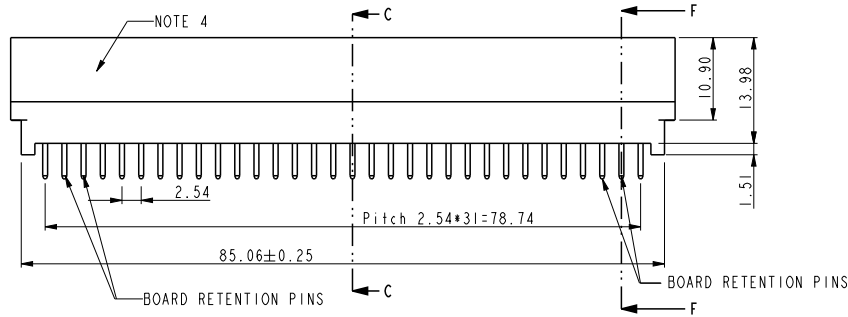
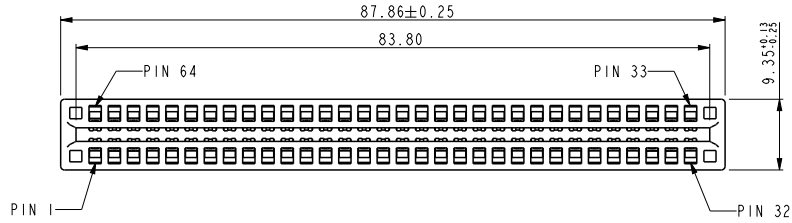
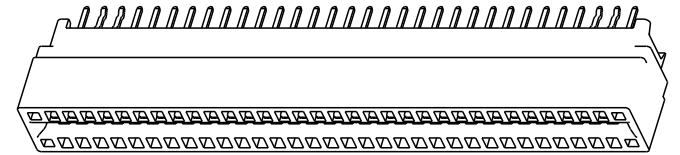
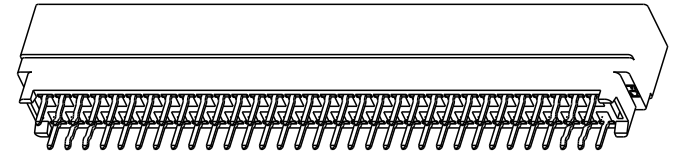

NOTE:

1. Material:  
HOUSING: HIGH TEMPERATURE THERMOPLASTIC,  
UL 94 V-0 FLAME RETARDANT.  
TERMINAL: HIGH CONDUCTIVITY COPPER ALLOY.  
PLATING SPEC AS BELOW:  
Ni 50u" UNDER PLATED.  
Au 30u" OVER CONTACT AREA.(ONE SIDE)  
Matte Tin 120u" OVER SOLDERING AREA.)
2. PACKING SPEC. GS-14-937.
3. PRODUCT SPEC. GS-12-338.
4. PRODUCT MARKING ON HOUSING IN AREA SHOWN MEETS AFci SPECIFICATION: GS-24-007.
5. A SYMBLE WILL BE NEXT TO ANY DIMENSION, VIEW, OR NOTE WHICH HAS BEEN MODIFIED WITH THE CURRENT DRAWING DEVISION.

spec ref	*	dr	w wcadmin	2006/08/24	projection	MM ←→	size	A4	scale	1.000
tolerance std	TOLERANCES UNLESS OTHERWISE SPECIFIED	eng	Sunny2 Liu	2016/04/12			ecn no	ELX-DG-22934-1		
		chr	Terris Liu	2016/05/20			rel level	Released		
surface	linear	0.X	±0.50	Amphenol FCi	title	PEC VT WITHOUT SIGNAL ASSY	dwg no	10046971	rev	H
		0.XX	±0.25							
		0.XXX	±0.10							
	angular	0°	±2°	cat. no.	*	Product - Customer Drw	sheet 1 of 4			

PART NUMBER 10046971-001LF

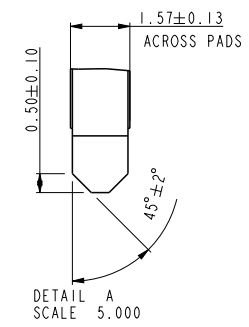
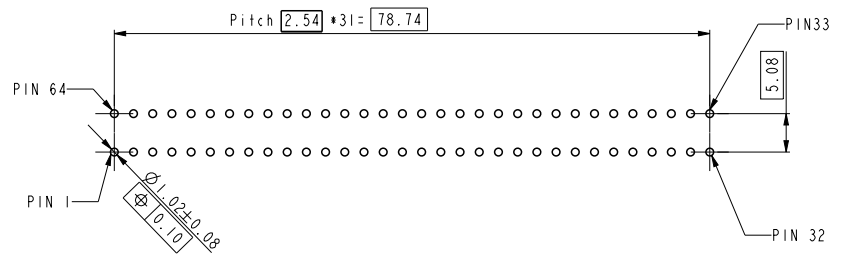
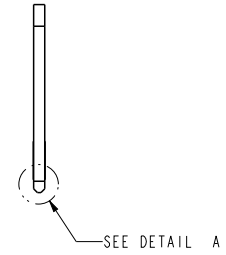
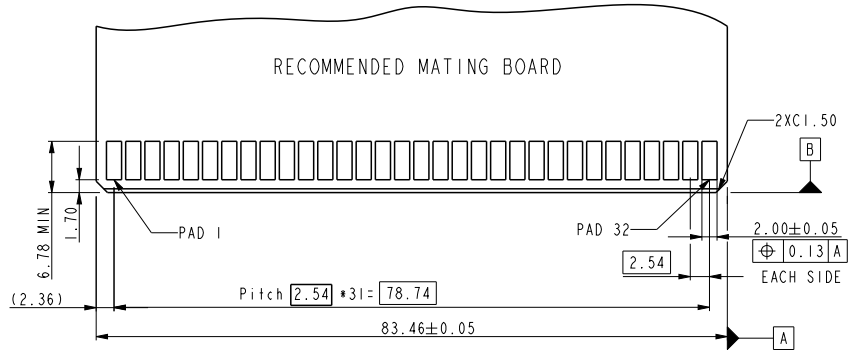

RECOMMENDED PC BOARD LAYOUT AND THE THICKNESS IS 2.36mm

Amphenol FCI

© 2016 AFCI

spec ref *		dr w cadmin		2006/08/24	projection 	MM ←→	size A4	scale 1.000
tolerance std		eng Sunny2 Liu		2016/04/12			ecn no ELX-DG-22934-1	
TOLERANCES UNLESS OTHERWISE SPECIFIED		chr Terris Liu		2016/05/20			rel level Released	
appr Pei-Ming Zheng		2016/05/24		product family				
surface	linear	0.X	±0.50	Amphenol FCI	title PEC VT	dwg no 10046971	rev H	
		0.XX	±0.25					
		0.XXX	±0.10					
angular	0°	±2°	cat. no. *	Product - Customer Drw		sheet 2 of 4		

Creo File - REV E - 2016-02-12

PART NUMBER	DIM A
10046971-003LF	3.17±0.50
10046971-055LF	4.00±0.50

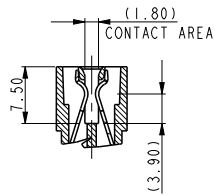
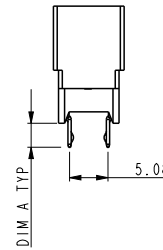
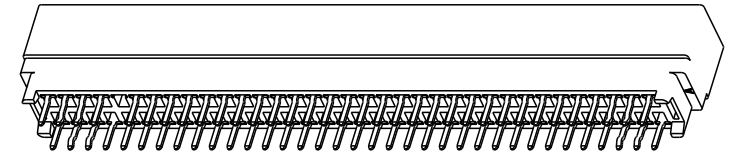
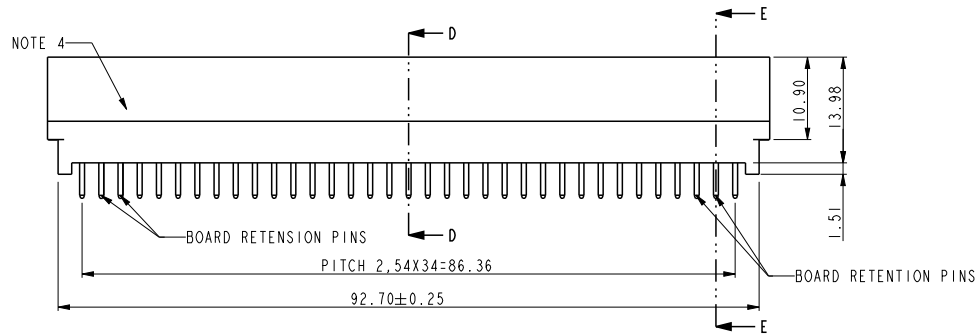
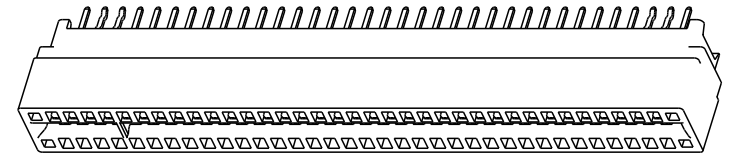
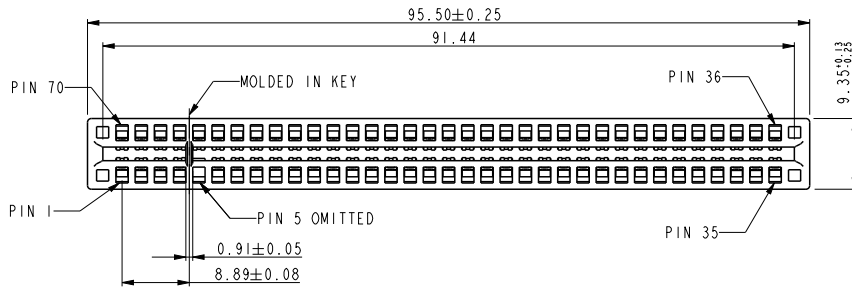

SECTION D-D



SECTION E-E  
BOARD RETENSION PINS

- NOTE:
- Material:  
HOUSING: HIGH TEMPERATURE THERMOPLASTIC,  
UL 94 V-0 FLAME RETARDANT.  
TERMINAL: HIGH CONDUCTIVITY COPPER ALLOY.  
PLATING SPEC AS BELOW:  
Ni 50u" UNDER PLATED.  
Au 30u" OVER CONTACT AREA.(ONE SIDE)  
Matte Tin 120u" OVER SOLDERING AREA.
  - PACKING SPEC. GS-14-937
  - PRODUCT SPEC. GS-12-338.
  - PRODUCT MARKING ON HOUSING IN AREA SHOWN MEETS AFCl SPECIFICATION: GS-24-007.
  - A SYMBOL WILL BE NEXT TO ANY DIMENSION, VIEW, OR NOTE WHICH HAS BEEN MODIFIED WITH THE CURRENT DRAWING DEVISION.

spec ref	*	dr	w wcadmin	2006/08/24	projection	MM	size	A4	scale	1.000
tolerance std	TOLERANCES UNLESS OTHERWISE SPECIFIED						ecn no ELX-DG-22934-1			
		eng	Sunny2 Liu	2016/04/12			rel level Released			
		chr	Terris Liu	2016/05/20						
		appr	Pei-Ming Zheng	2016/05/24	product family					
surface	linear	0.X	±0.50		title PEC VT WITHOUT SIGNAL ASSY		dwg no 10046971		rev H	
		0.XX	±0.25							
		0.XXX	±0.10							
	angular	0°	±2°	cat. no.		Product - Customer Drw		sheet 3 of 4		

PART NUMBER
10046971-003LF
10046971-055LF

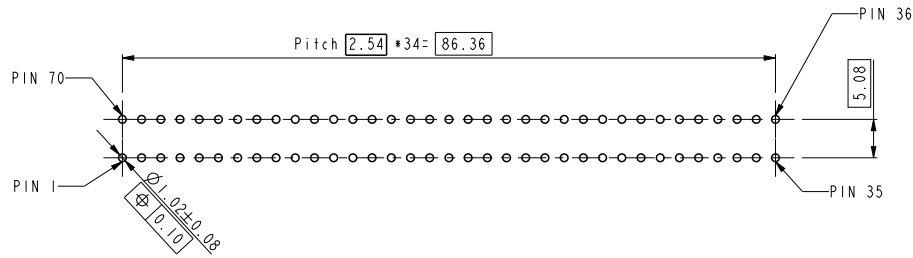
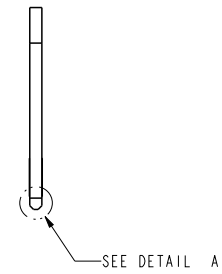
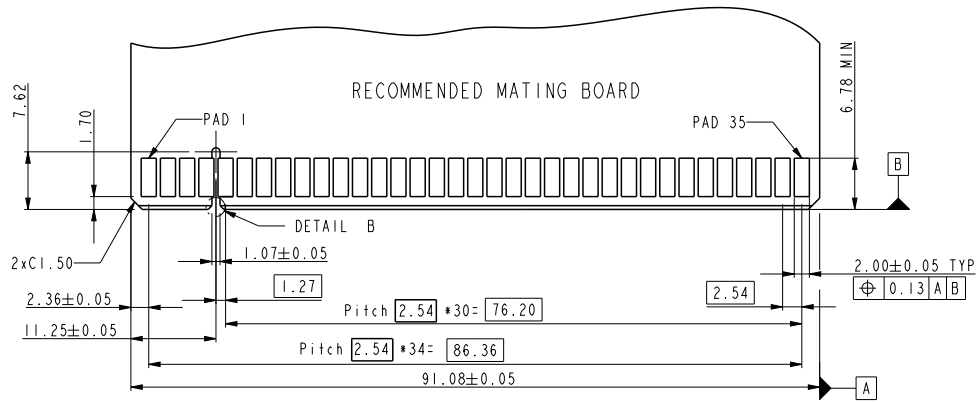

RECOMMENDED PC BOARD LAYOUT  
AND THE THICKNESS IS 2.36mm

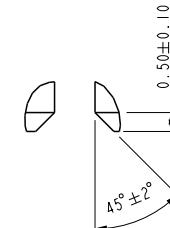

DETAIL B  
SCALE 5.000

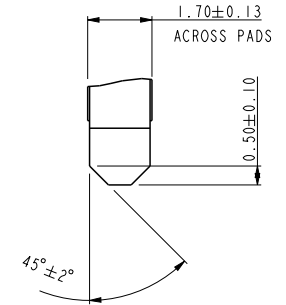

DETAIL A  
SCALE 5.000

spec ref	*	dr	w cadmin	2006/08/24	projection	MM ←→	size	A4	scale	1.000				
tolerance std	TOLERANCES UNLESS OTHERWISE SPECIFIED	eng	Sunny2 Liu	2016/04/12			ecn no	ELX-DG-22934-1						
		chr	Terris Liu	2016/05/20			product family	rel level	Released					
surface	linear	0.X	±0.50	Amphenol FCi	PEC VT WITHOUT SIGNAL ASSY			dwg no	10046971		rev	H		
		0.XX	±0.25								cat. no.	*	Product - Customer Drw	sheet 4 of 4
	angular	0°	±2°											